

D-129-0043 to D-129-15 Solder sleeve wire terminator, conical

These solder sleeves made from transparent polyvinylidene fluoride provides encapsulation, inspectability, strain relief and insulation. The prefluxed solder preform offers a controlled soldering process. The one-piece design means easy installation and low installed cost.

Specifications / Approvals: UL and CUL E87681

D-129-0043

Temperature	
Operating Temperature	-65°C to +125°C

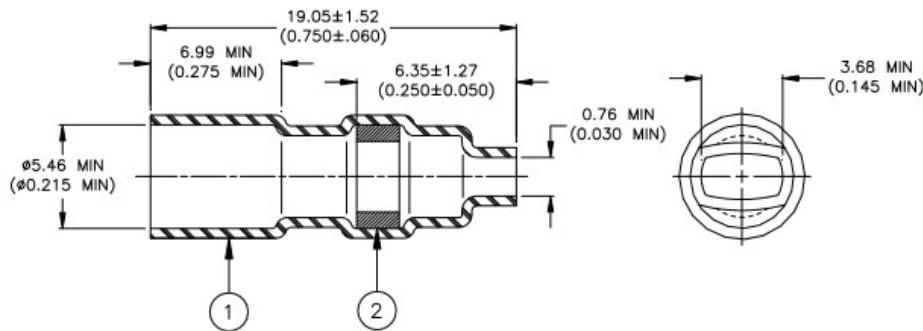

- 1: Heat shrink tube, transparent blue, cross-linked polyvinylidene fluoride
- 2: Solder ring: Type SN63 per ANSI-J-STD-006 and Flux Type ROL1 per ANSI-J-STD-004

D-129-03

Temperature	
Operating Temperature	-55°C to +150°C

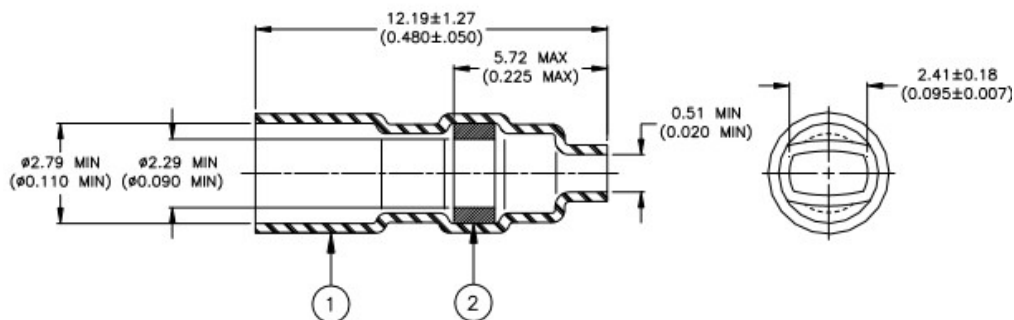

- 1: Heat shrink tube, transparent blue, cross-linked polyvinylidene fluoride
- 2: Solder ring: Type SN63 per ANSI-J-STD-006 and Flux Type ROL1 per ANSI-J-STD-004

D-129-05

Temperature

Operating Temperature -55°C to +150°C

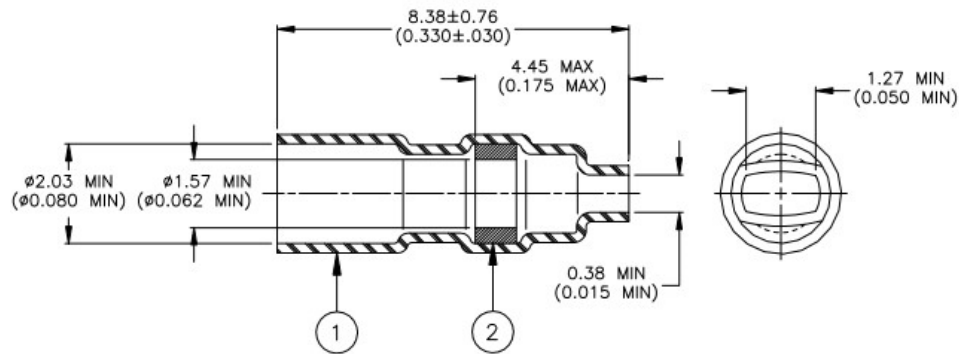

- 1: Heat shrink tube, transparent blue, cross-linked polyvinylidene fluoride
- 2: Solder ring: Type SN63 per ANSI-J-STD-006 and Flux Type ROL1 per ANSI-J-STD-004

D-129-11

Temperature

Operating Temperature -55°C to +150°C

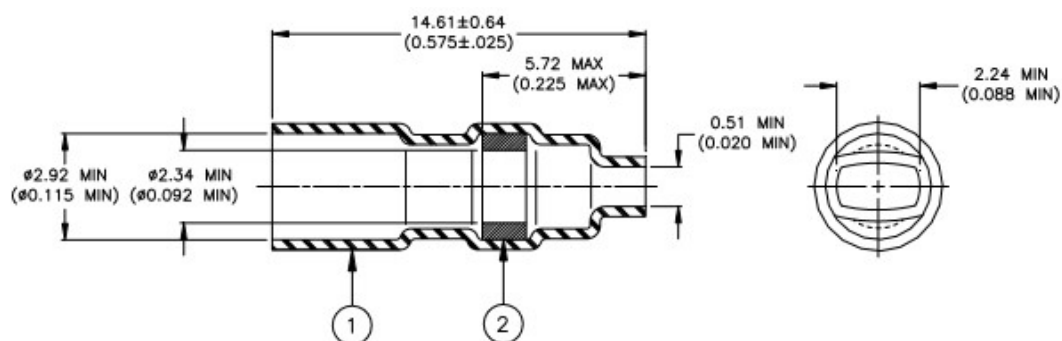

- 1: Heat shrink tube, transparent blue, cross-linked polyvinylidene fluoride
- 2: Solder ring: Type SN63 per ANSI-J-STD-006 and Flux Type ROL1 per ANSI-J-STD-004

D-129-15

Temperature

Operating Temperature -65°C to +125°C

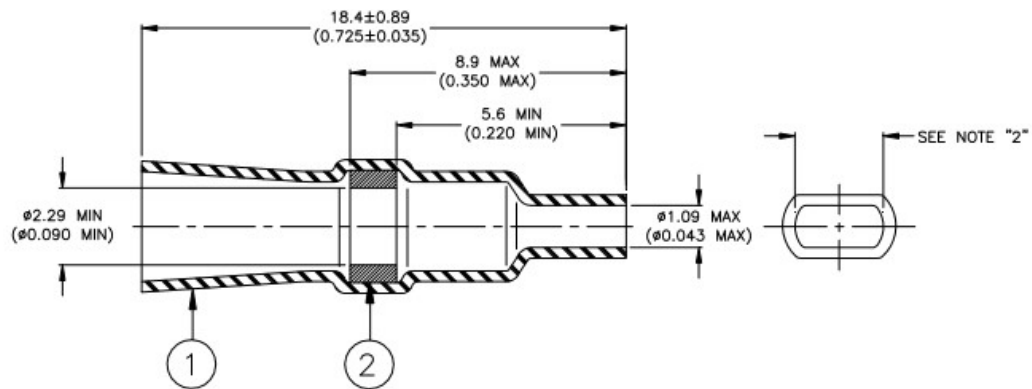

1: Heat shrink tube, transparent blue, cross-linked polyvinylidene fluoride

2: Solder ring: Type SN63 per ANSI-J-STD-006 and Flux Type ROL1 per ANSI-J-STD-004